

TWINBROOK I

5640 FISHERS LANE

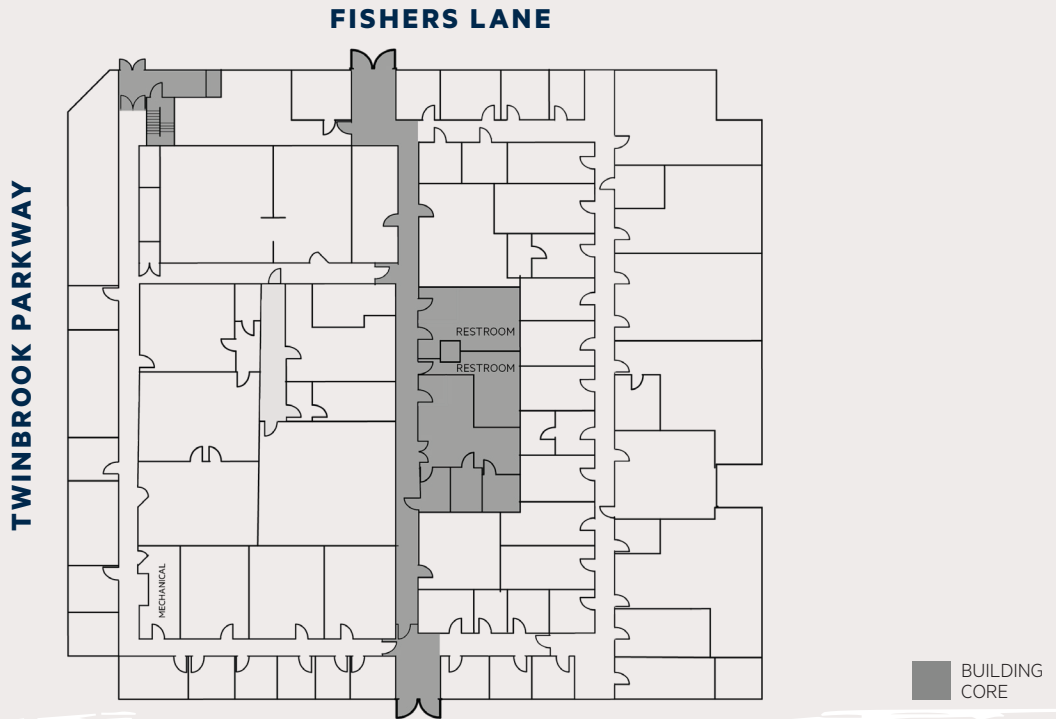

5640 FISHERS LANE | 24,269 SF LAB

GLENLINE
INVESTMENTS

Available

24,269 sf

Parking

150 spaces/shared with Twinbrook II

Clear Height

14 ft

Features

Repositioning existing lab buildings previously occupied by NIH.
Common corridor and facilities.
Grade level loading.

Equipment Summary

2-150HP low pressure steam boilers
Dual heat exchangers
2-270 ton chillers
3-Manifold Lab Air Handlers with 100% Outside Air
2-Manifold office air handlers
Central gas water heaters
2' CW
6" Fire
Siemens Apogee DDC Pneumatic
2,000AMP 277/480V electric feed

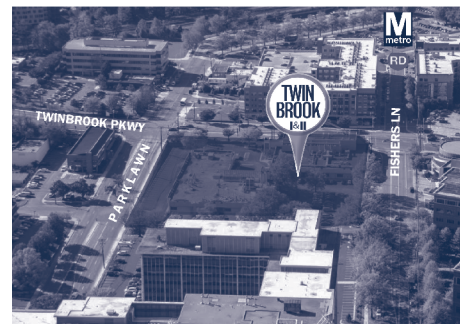

Minkoff

240.912.0200 | minkoffdev.com

REAL ESTATE
PERSONAL PERSPECTIVE